



## 141 Cherry Springs Lane Asheville, NC 28804

### BEDROOMS

**3**

### BATHROOMS

**2 1/2**

### CAR GARAGES

**1**

### HEATED SQ. FT.

**1,640**

### PRICE

**442,000**

## Interior Highlights

- Open Concept Main Living Area
- Soft Close Cabinets
- Stainless Steel Appliances
- Primary Suite on Main Level with Vaulted Ceilings
- Quartz Countertops
- Upgraded Lighting Package
- 3 Bedrooms, 2 1/2 Baths

## Exterior Highlights

- Craftsman Style Front
- Single Car Garage
- Private Patio
- Interior Unit
- Lawn Maintenance Included in HOA





# Floorplans

*The Lily 1500 Plan - First Floor*

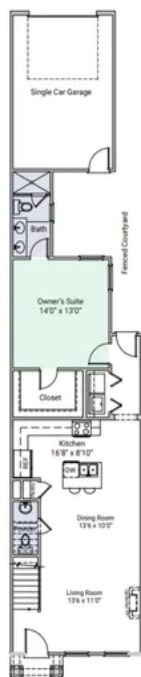

*The Lily 1500 Plan - Second Floor*

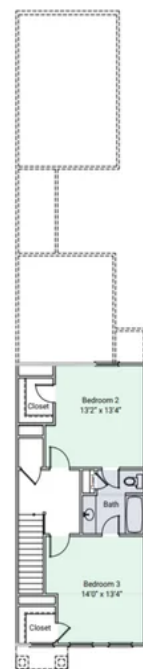



## The Lily 1600 Plan



4.12.24

# Gallery

Representative Photo

